

Industrial Sensor 4716

Compact open type for sluice

4-electrode conductivity sensor with external electrodes.
Used with Dual Conductivity TCU series 3200.

| Technical data | |
|----------------|---|
| Materials | Sensor: PTFE, silicone rubber and W 1.4404 (AISI 316L) steel Sensor packing: O-ring EPDM Sluice valve packing: PTFE |
| Pressure | 12 bar at 150 °C During withdrawal max. 5 bar |
| Cell constant | Sensor specific, factory calibrated |
| Accuracy | ± 2 % |
| Meas. range | 5...200 000 µS/cm |
| Linearity | ± 2 % per decade |
| Temp. sensor | Pt 1000 (IEC 751 class A) Time delay T ₉₀ , 9 sec |
| Protection | IP65 splash-proof (DIN 40 050) |
| Sensor cable | PVC 18 x 0.22 mm ² screened max. temp. 70 °C |
| Cable length | Standard length 5 m COND15242/10 -> 10 m COND15242/15 -> 15 m |
| Connection | 15-pole strip connector with MF20 cable adapter |
| Weight | Sensor 2.9 kg Sluice chamber 3.0 kg |

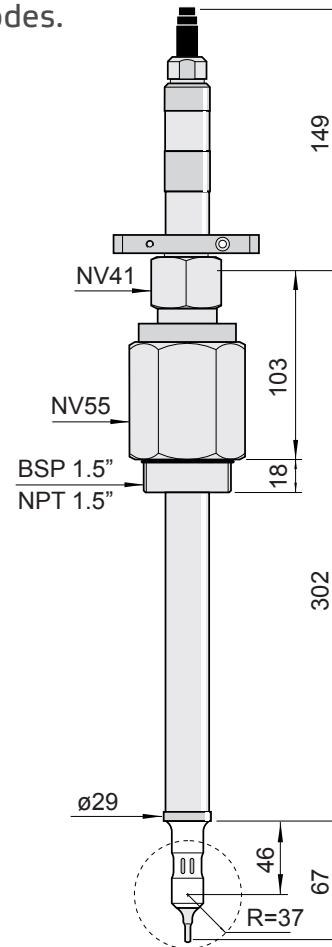

dimensions in millimeters

Sluice chamber 8299

1.5" ball valve for sensor mounting

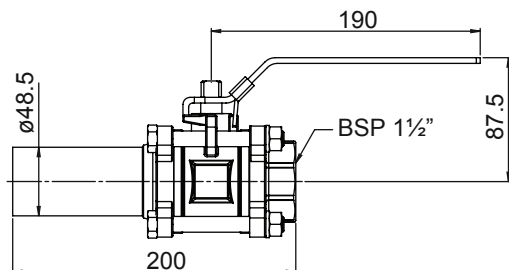

Typical mounting

4716 with 8299

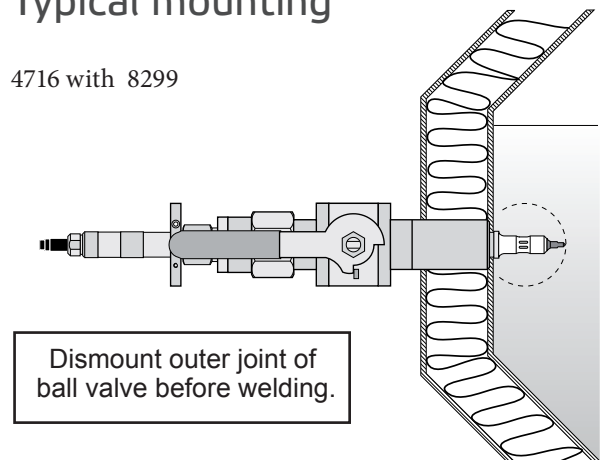

Industrial Sensor 4719

Radiation resistant sensor

4-electrode conductivity sensor with internal electrodes.
Used with Dual Conductivity TCU series 3200.

| Technical data | |
|----------------|---|
| Radiation | Resistant to 1.00E+05 Gy, 121 °C |
| Materials | PVDF, Viton, EPDM silicone rubber, and steel W 1.4404 (AISI 316L) |
| Pressure | 10 bar at 130 °C |
| Cell constant | Sensor specific, factory calibrated |
| Accuracy | ± 1.5 % or min. ± 8 nS/cm |
| Meas. range | 0.05...10 000 µS/cm |
| Linearity | ± 1 % per decade Below 5 µS/cm +8 nS/cm |
| Temp. sensor | Pt 1000 (IEC 751 class A) Time delay T ₉₀ , 15 sec |
| Protection | IP65 splash-proof (DIN 40 050) |
| Sensor cable | PVC 18 x 0.22 mm ² screened max. temp. 70 °C |
| Cable length | Standard length 5 m COND15242-10 → 10 m COND15242-15 → 15 m |
| Connection | 15-pole strip connector with MF20 cable adapter |
| Weight | 1.0 kg |

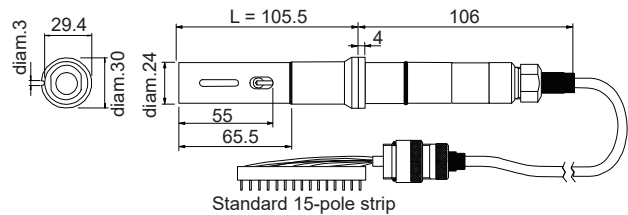
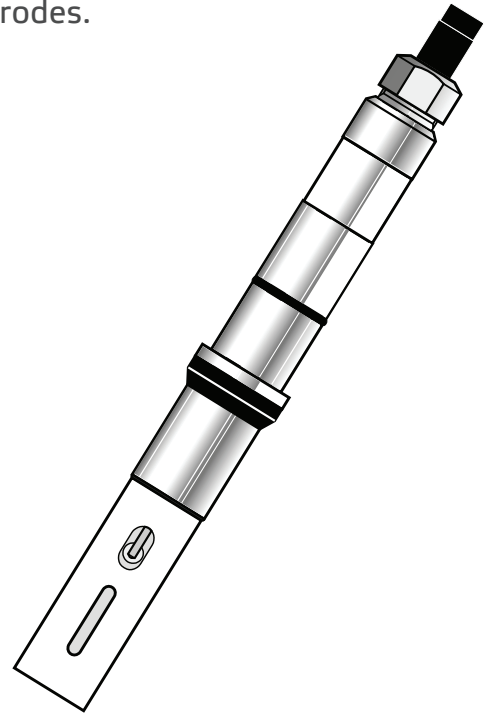

dimensions in millimeters

Typical mounting

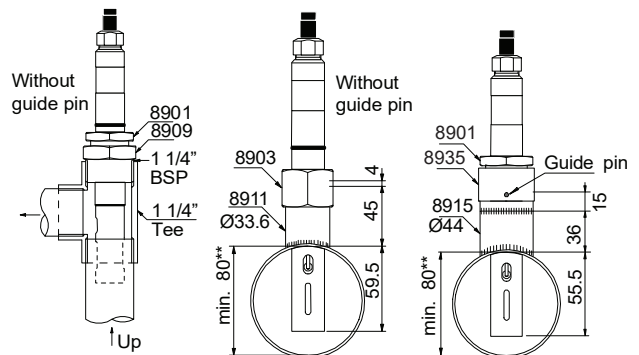
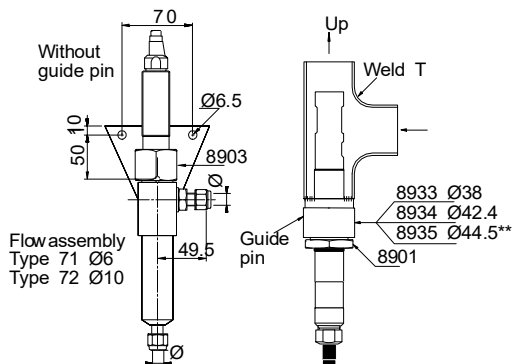

For more information, contact your local Valmet office. www.valmet.com

Specifications in this document are subject to change without notice.
Product names in this publication are all trademarks of Valmet Corporation.



Industrial Sensor 4721

Industrial closed sensor for small pipes

4-electrode conductivity sensor with internal electrodes.
Used with Dual Conductivity TCU series 3200.

| Technical data | |
|----------------|---|
| Materials | PTFE and steel W 1.4404 (AISI 316L) |
| Pressure | 25 bar at 210 °C |
| Cell constant | Sensor specific, factory calibrated |
| Accuracy | ± 1.5 % or min. ± 8 nS/cm |
| Meas. range | 0.05...200 000 µS/cm |
| Linearity | ± 1 % per decade Below 5 µS/cm +8 nS/cm |
| Temp. sensor | Pt 1000 (IEC 751 class A) Time delay T ₉₀ , 20 sec |
| Protection | IP65 splash-proof (DIN 40 050) |
| Sensor cable | PVC 18 x 0.22 mm ² screened max. temp. 70 °C |
| Cable length | Standard length 5 m COND15242-10 → 10 m COND15242-15 → 15 m |
| Connection | 15-pole strip connector with MF20 cable adapter |
| Weight | 1.0 kg |

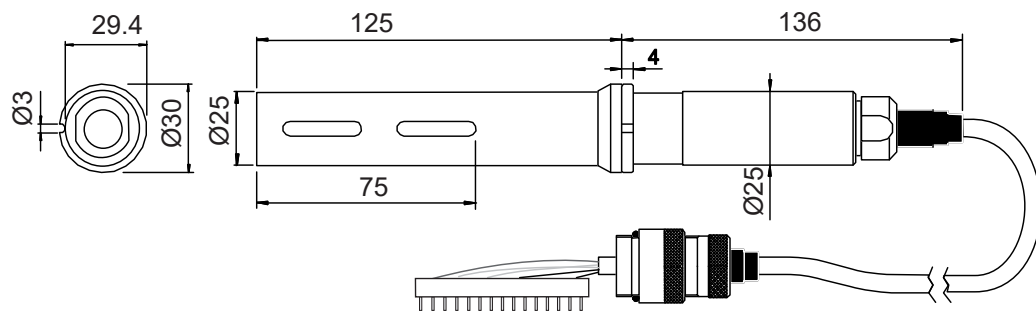

dimensions in millimeters

Typical mounting

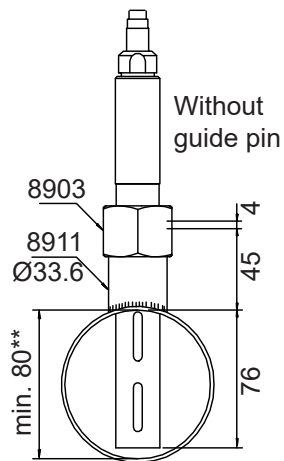
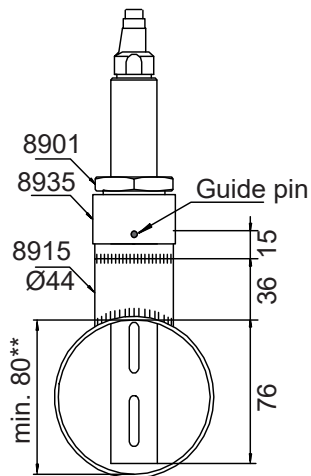
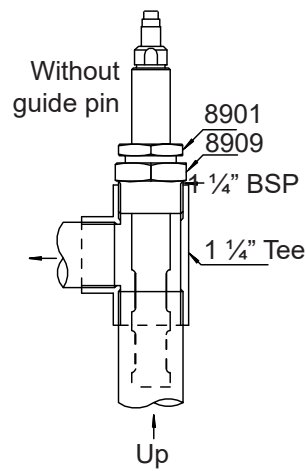
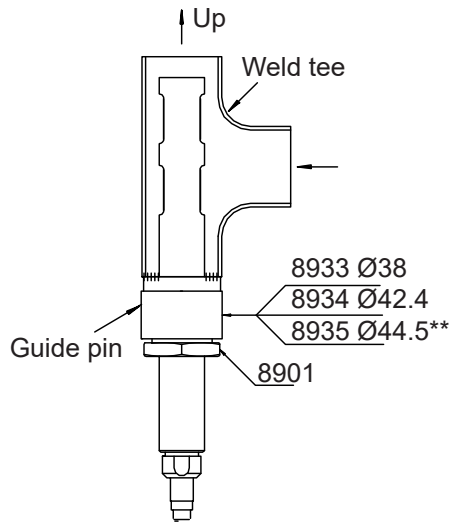
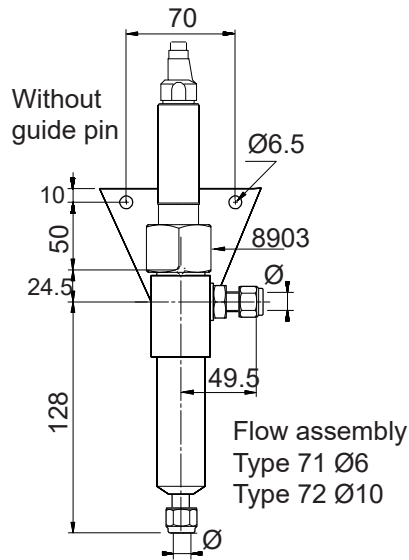

Industrial Sensor 4721 HP

Industrial closed sensor for small pipes and high pressures

4-electrode conductivity sensor with internal electrodes.
Delivered with pressure test certificate.
Used with Dual Conductivity TCU series 3200.

| Technical data | |
|----------------|---|
| Materials | PTFE and steel W 1.4404 (AISI 316L) |
| Pressure | 50 bar at 250 °C |
| Cell constant | Sensor specific, factory calibrated |
| Accuracy | ± 1.5 % or min. ± 8 nS/cm |
| Meas. range | 0.05...200 000 µS/cm |
| Linearity | ± 1 % per decade Below 5 µS/cm +8 nS/cm |
| Temp. sensor | Pt 1000 (IEC 751 class A) Time delay T ₉₀ , 20 sec |
| Protection | IP65 splash-proof (DIN 40 050) |
| Sensor cable | PVC 18 x 0.22 mm ² screened max. temp. 70 °C |
| Cable length | Standard length 5 m COND15242-10 → 10 m COND15242-15 → 15 m |
| Connection | 15-pole strip connector with MF20 cable adapter |
| Weight | 1.0 kg |

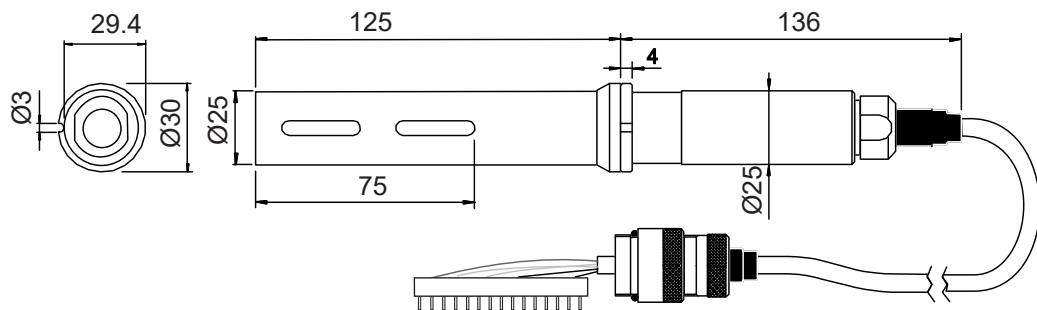

dimensions in millimeters

Typical mounting

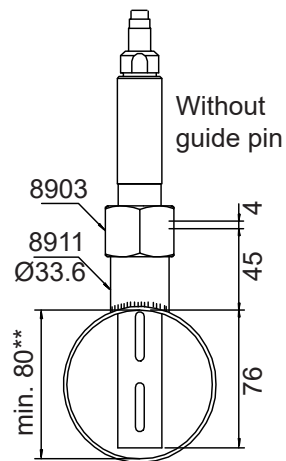
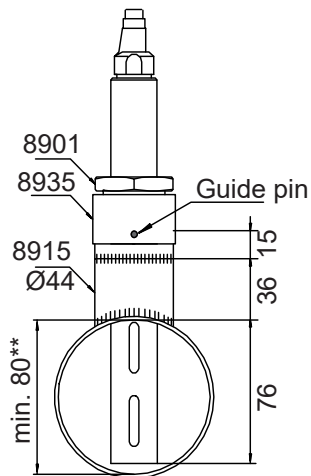
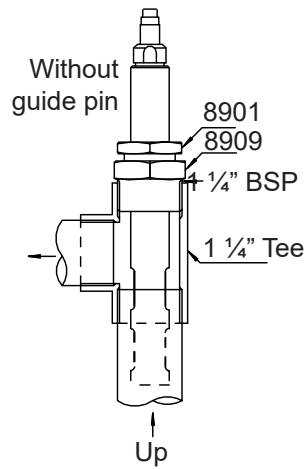
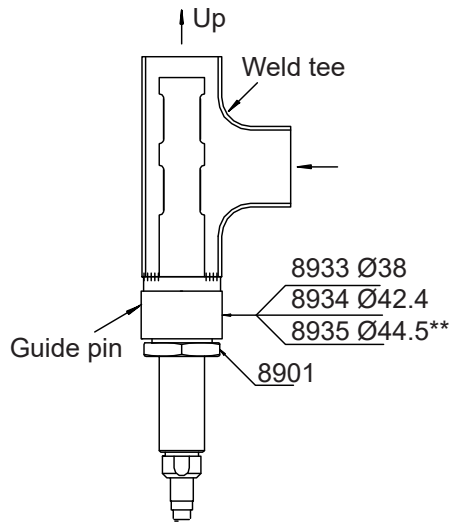
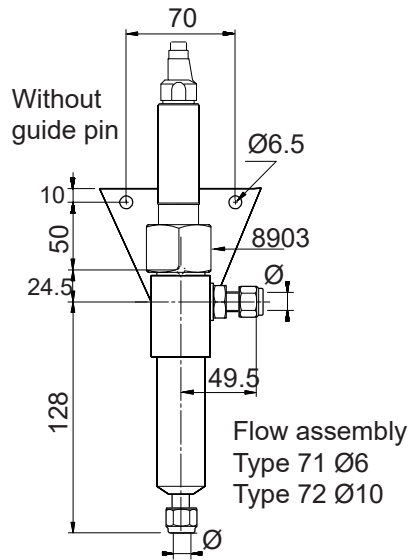

Industrial Sensor 4721PE

Radiation resistant closed sensor for small pipes

4-electrode conductivity sensor with internal electrodes.
Used with Dual Conductivity TCU series 3200.

| Technical data | |
|----------------|---|
| Materials | PE and steel W 1.4404 (AISI 316L) |
| Pressure | 20 bar at 80 °C |
| Cell constant | Sensor specific, factory calibrated |
| Accuracy | ± 1.5 % or min. ± 8 nS/cm |
| Meas. range | 0.05...200 000 µS/cm |
| Linearity | ± 1 % per decade Below 5 µS/cm +8 nS/cm |
| Temp. sensor | Pt 1000 (IEC 751 class A) Time delay T_{90} , 20 sec |
| Protection | IP65 splash-proof (DIN 40 050) |
| Sensor cable | PVC 18 x 0.22 mm ² screened max. temp. 70 °C |
| Cable length | Standard length 5 m COND15242-10 → 10 m COND15242-15 → 15 m |
| Connection | 15-pole strip connector with MF20 cable adapter |
| Weight | 1.0 kg |

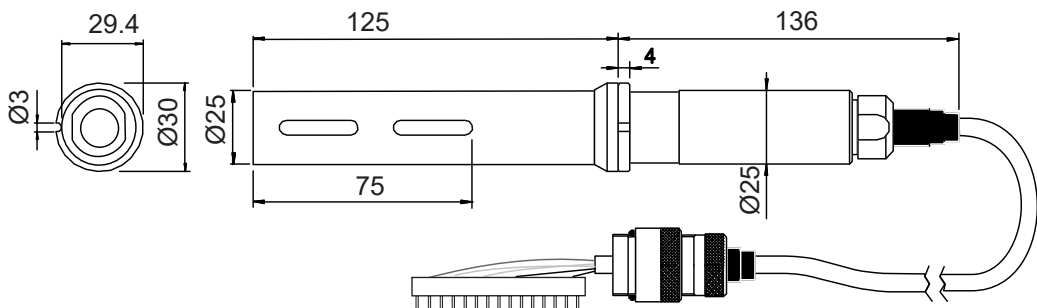
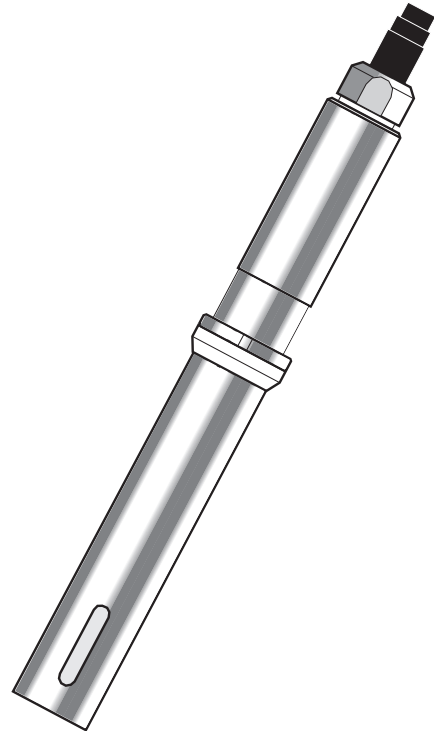

dimensions in millimeters

Typical mounting

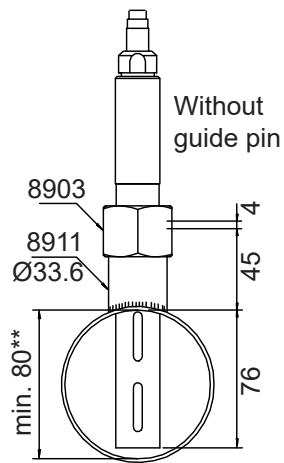
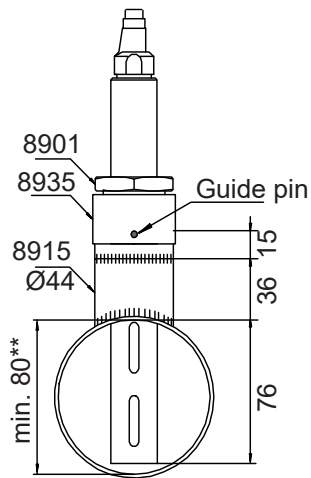
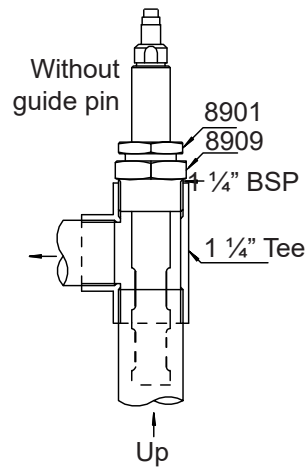
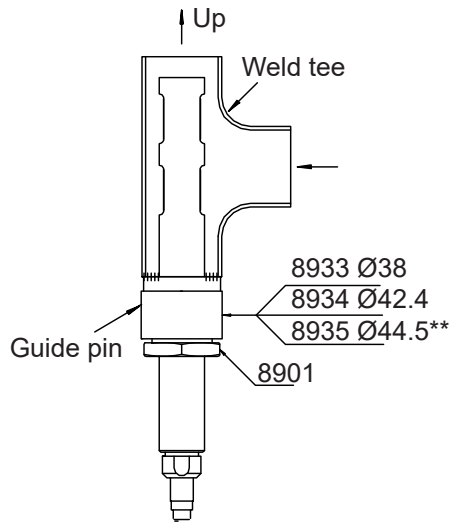
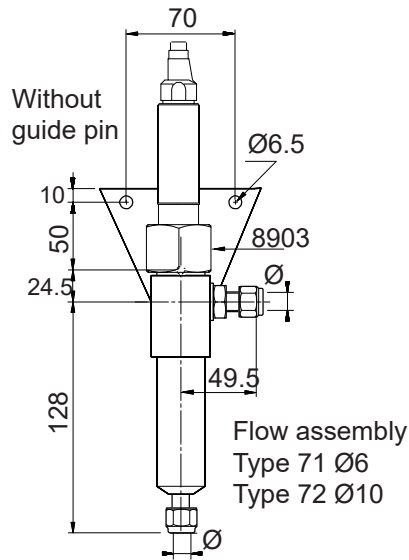

Industrial Sensor 4722

Industrial closed sensor for small pipes

4-electrode conductivity sensor with internal electrodes.
Used with Dual Conductivity TCU series 3200.

| Technical data | |
|----------------|---|
| Length | L = 0.25 m or extended to 0.5 / 1.0 / 1.5 / 2.0 / 2.5 m |
| Materials | PTFE and steel W 1.4404 (AISI 316L) |
| Pressure | 25 bar at 210 °C |
| Cell constant | Sensor specific, factory calibrated |
| Accuracy | ± 1.5 % or min. ± 8 nS/cm |
| Meas. range | 0.05...200 000 µS/cm |
| Linearity | ± 1 % per decade Below 5 µS/cm +8 nS/cm |
| Temp. sensor | Pt 1000 (IEC 751 class A) Time delay T ₉₀ , 20 sec |
| Protection | IP65 splash-proof (DIN 40 050) |
| Sensor cable | PVC 18 x 0.22 mm ² screened max. temp. 70 °C |
| Cable length | Standard length 5 m COND15242-10 → 10 m COND15242-15 → 15 m |
| Connection | 15-pole strip connector with MF20 cable adapter |
| Weight | 1.3 kg |

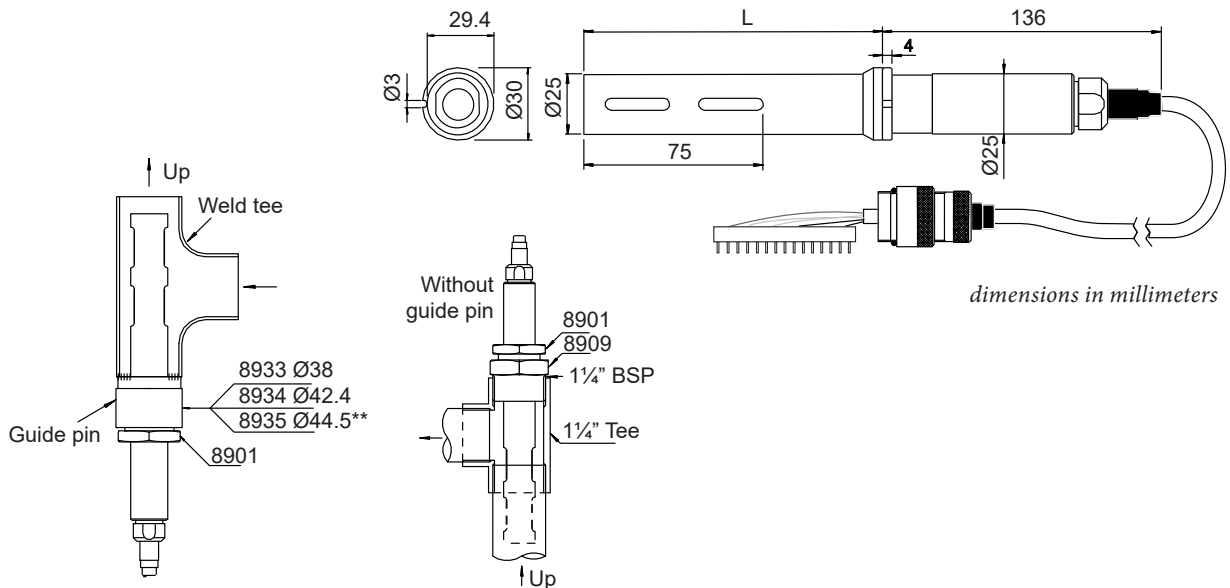
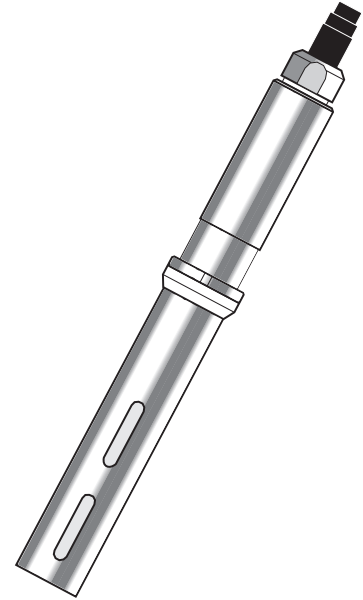

For more information, contact your local Valmet office. www.valmet.com

Specifications in this document are subject to change without notice.
Product names in this publication are all trademarks of Valmet Corporation.

Industrial sensor 4723

Durable industrial sensor for sluice chamber

4-electrode conductivity sensor with internal electrodes.
Used with TCU series 3200.

| Technical data | |
|----------------|--|
| Materials | Sensor: PTFE and steel W 1.4404 (AISI 316L) Packings: PTFE |
| Pressure | 15 bar at 150 °C During withdrawal max. 5 bar |
| Cell constant | Sensor specific, factory calibrated |
| Accuracy | ± 1.5 % or ± 8 nS/cm |
| Meas. range | 0.05...200 000 µS/cm |
| Linearity | ± 1 % per decade Below 5 µS/cm +8 nS/cm |
| Temp. sensor | Pt 1000 (IEC 751 class A) Time delay T ₉₀ , 20 sec |
| Protection | IP65 splash-proof (DIN 40 050) |
| Sensor cable | PVC 18 x 0.22 mm ² screened max. temp. 70 °C |
| Cable length | Standard length 5 m COND15242-10 →v 10 m COND15242-15 → 15 m |
| Connection | 15-pole strip connector with MF20 cable adapter |
| Weight | Sensor 3.0 kg Sluice chamber 3.5 kg |



dimensions in millimeters

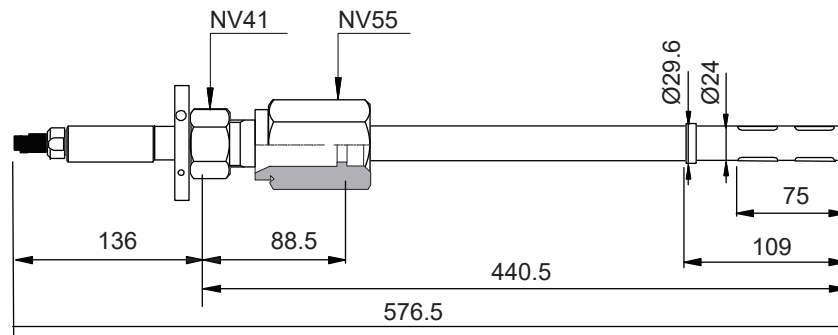

Typical mounting

- Dismount the outer joint of ball valve before welding!

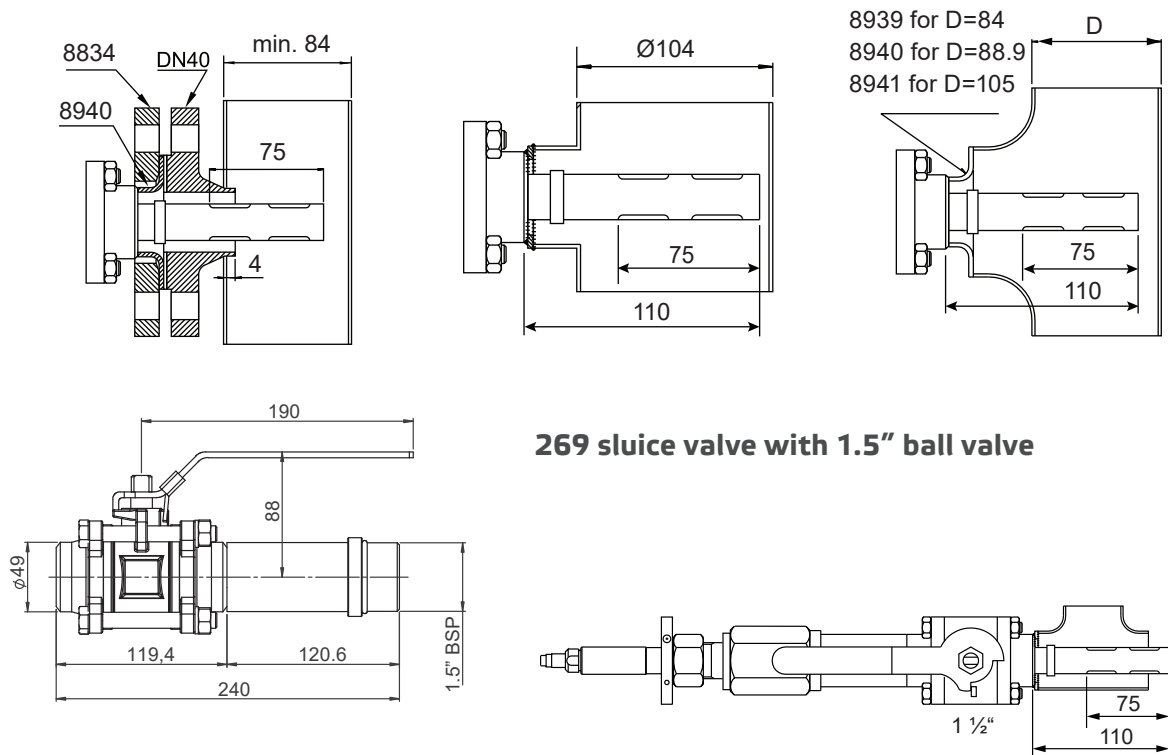

- When installing, apply lubricating grease to the thread to prevent seizing.
- For the removal of the sensor with sluce mounting, there must be at least 820 mm of free space directly behind the installation, measured from the mounting surface of the sluce valve.

1. Make a hole to the process pipe; diameter must be at least equal to the sluce valve inside diameter.
2. Carefully center the sluce valve with the hole. Sluce valve must be installed perpendicular to the pipe. If the hole is larger than the sluce valve, make sure the valve does not protrude deep inside the pipeline.
3. Weld carefully all around the sluce valve to fasten it.

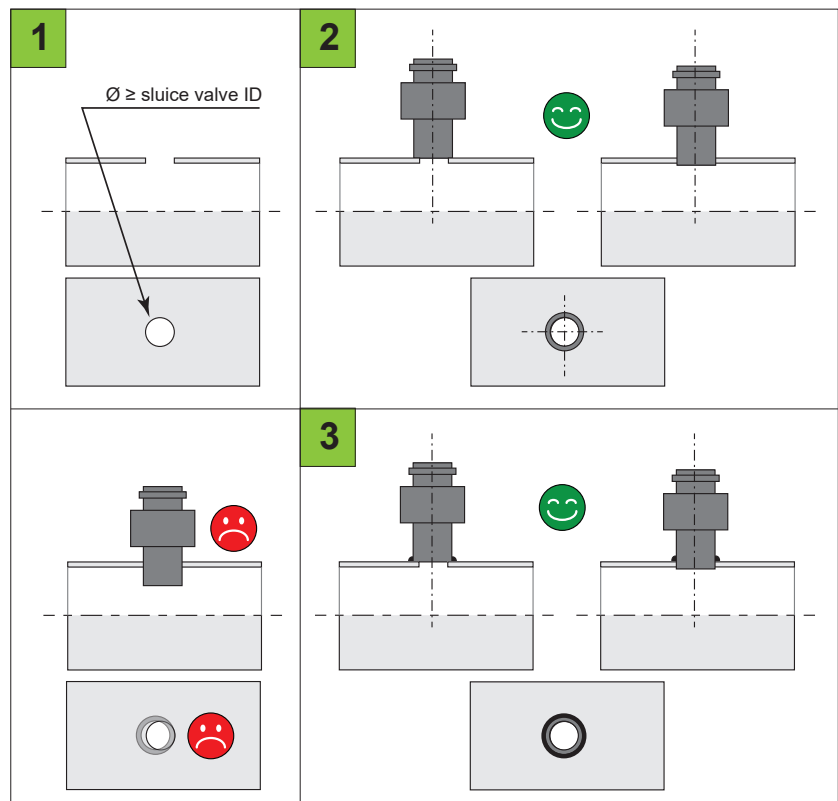

For more information, contact your local Valmet office. www.valmet.com

Specifications in this document are subject to change without notice.
Product names in this publication are all trademarks of Valmet Corporation.

Industrial Sensor 4724

Industrial open sensor

4-electrode conductivity sensor with external electrodes.
Used with Dual Conductivity TCU series 3200.

| Technical data | |
|----------------|---|
| Materials | PTFE and steel W 1.4404 (AISI 316L) |
| Pressure | 25 bar at 210 °C |
| Cell constant | Sensor specific, factory calibrated |
| Accuracy | ± 1.5 % or ± 0.01 µS/cm |
| Meas. range | 0.05...200 000 µS/cm |
| Linearity | ± 2 % per decade Below 5 µS/cm +0.01 µS/cm |
| Temp. sensor | Pt 1000 (IEC 751 class A) Time delay T_{90} , 25 sec |
| Protection | IP65 splash-proof (DIN 40 050) |
| Sensor cable | PVC 18 x 0.22 mm ² screened max. temp. 70 °C |
| Cable length | Standard length 5 m COND15242/10 -> 10 m COND15242/15 -> 15 m |
| Connection | 15-pole strip connector with MF20 cable adapter |
| Weight | 1.1 kg |

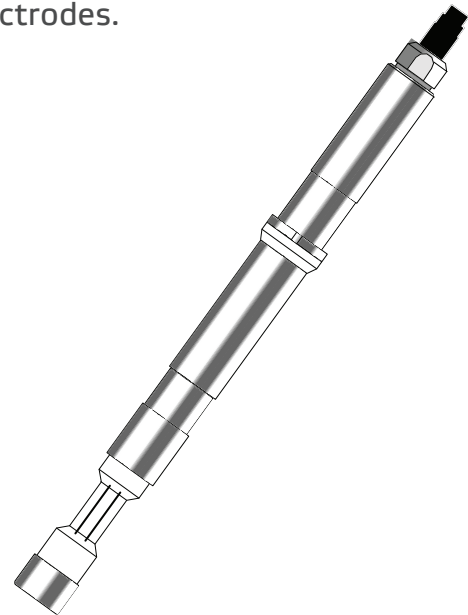

dimensions in millimeters

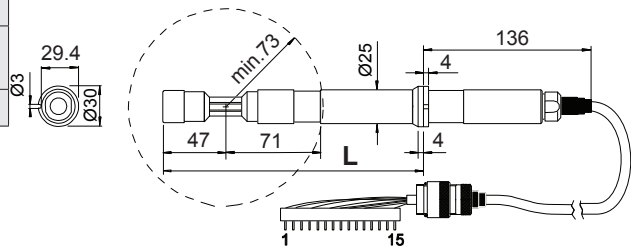

Typical mounting

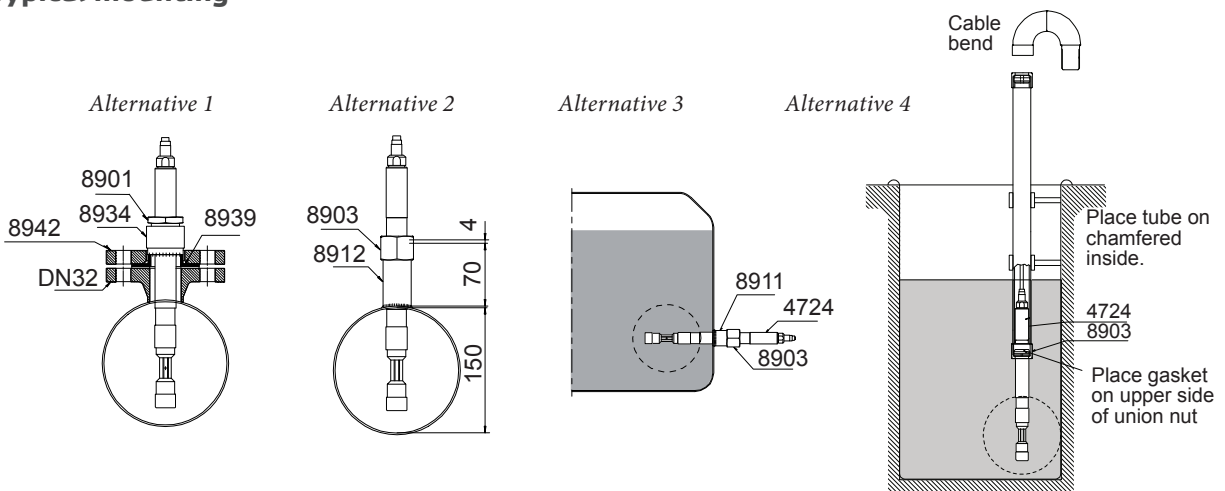

For more information, contact your local Valmet office. www.valmet.com

Specifications in this document are subject to change without notice.
Product names in this publication are all trademarks of Valmet Corporation.

Industrial Sensor 4725

Industrial open sensor

4-electrode conductivity sensor with external electrodes.
Used with Dual Conductivity TCU series 3200.

| Technical data | |
|----------------|---|
| Length | 0.25 m or extended to 0.5 / 1.0 / 1.5 / 2.0 / 2.5 m |
| Materials | PTFE and steel W 1.4404 (AISI 316L) |
| Pressure | 25 bar at 210 °C |
| Cell constant | Sensor specific, factory calibrated |
| Accuracy | ± 1.5 % or ± 0.01 µS/cm |
| Meas. range | 0.05...200 000 µS/cm |
| Linearity | ± 2 % per decade Below 5 µS/cm +0.01 µS/cm |
| Temp. sensor | Pt 1000 (IEC 751 class A) Time delay T ₉₀ , 25 sec |
| Protection | IP65 splash-proof (DIN 40 050) |
| Sensor cable | PVC 18 x 0.22 mm ² screened max. temp. 70 °C |
| Cable length | Standard length 5 m COND15242-10 → 10 m COND15242-15 → 15 m |
| Connection | 15-pole strip connector with MF20 cable adapter |
| Weight | 1.1 kg |

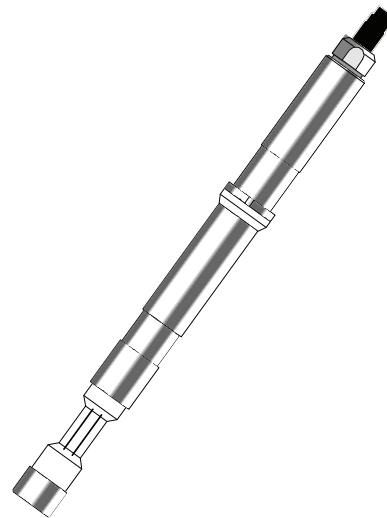

Typical mounting

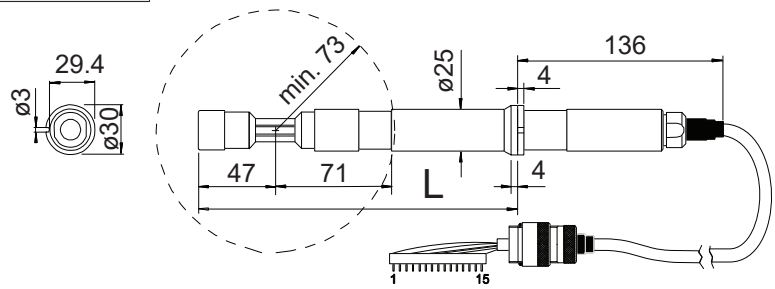
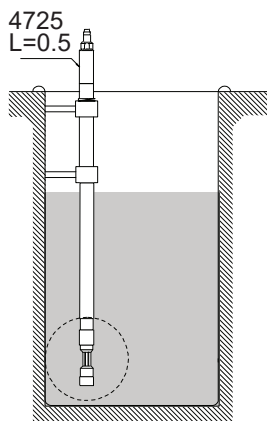

dimensions in millimeters

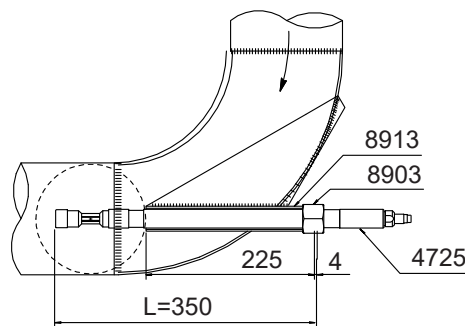

For more information, contact your local Valmet office. www.valmet.com

Specifications in this document are subject to change without notice.
Product names in this publication are all trademarks of Valmet Corporation.



Industrial sensor 4726

Durable industrial sensor for sluice chamber

4-electrode conductivity sensor with external electrodes.
Used with TCU series 3200.

| Technical data | |
|----------------|---|
| Materials | Sensor: PTFE and steel W 1.4404 (AISI 316L) Sensor & sluice valve packings: PTFE |
| Pressure | 15 bar at 150 °C During withdrawal max. 5 bar |
| Cell constant | Sensor specific, factory calibrated |
| Accuracy | ± 1.5% or ± 0.01 µS/cm |
| Meas. range | 0.05...200 000 µS/cm |
| Linearity | ± 2 % per decade Below 5 µS/cm + 0.01 µS/cm |
| Temp. sensor | Pt 1000 (IEC 751 class A) Time delay T ₉₀ , 25 sec |
| Protection | IP65 splash-proof (DIN 40 050) |
| Sensor cable | PVC 18 x 0.22 mm ² screened max. temp. 70 °C |
| Cable length | Standard length 5 m COND15242/10 -> 10 m COND15242/15 -> 15 m |
| Connection | 15-pole strip connector with MF20 cable adapter |
| Weight | Sensor 3.0 kg Sluice chamber 3.5 kg |



dimensions in millimeters

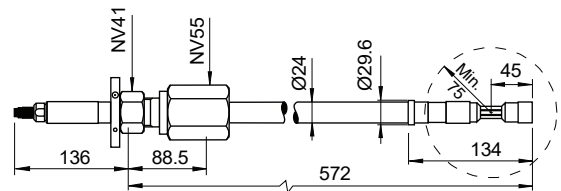

270 sluice chamber with 1.5" ball valve

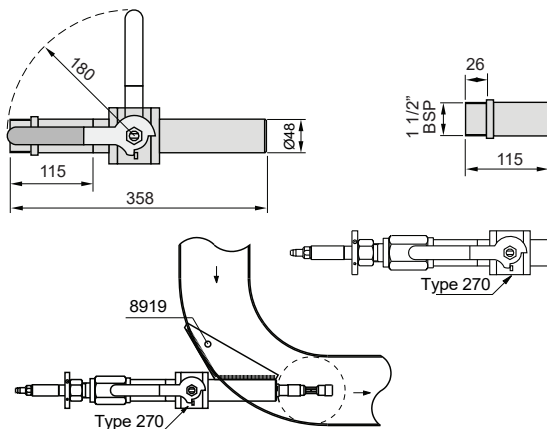

Typical installation

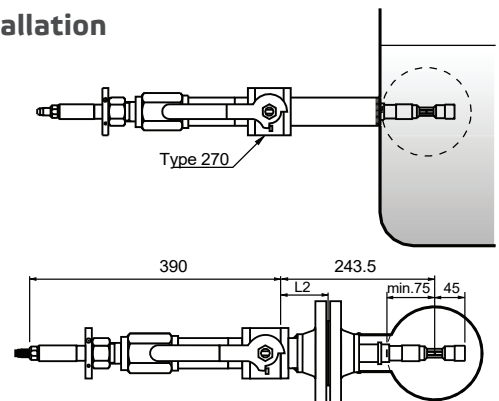

269 sluice valve with 1.5" ball valve

271 flanged sluice chamber (DIN DN10, PN40)

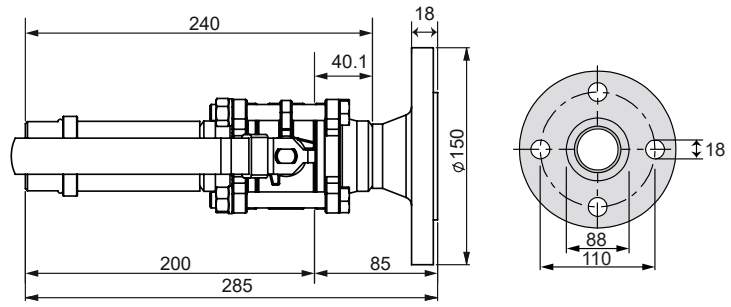
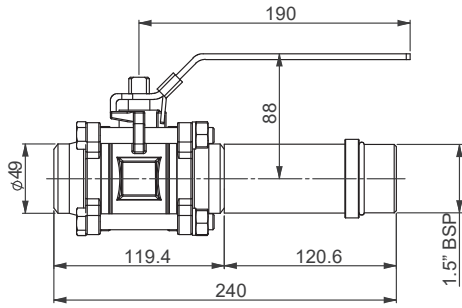

Typical installation

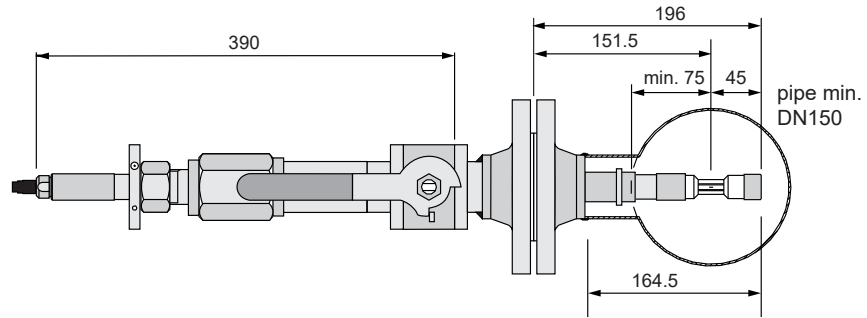

dimensions in millimeters

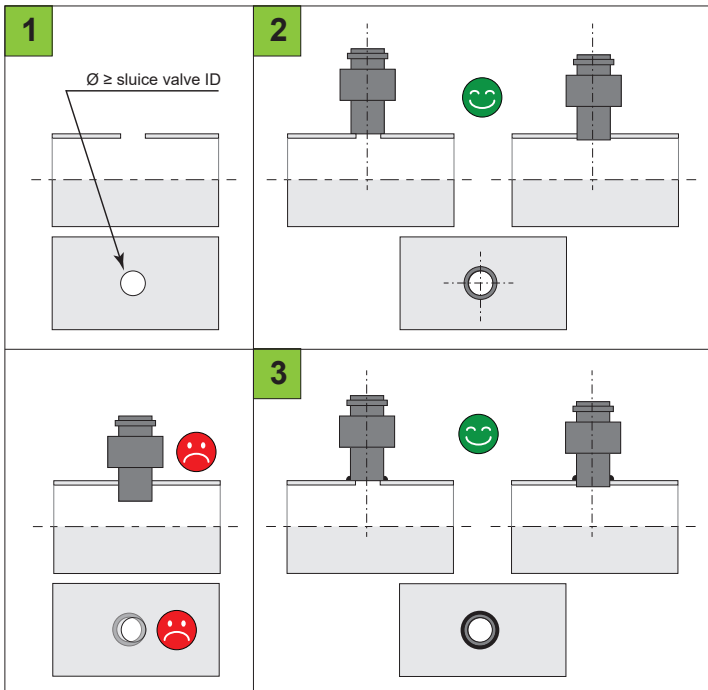

1. Make a hole to the process pipe; diameter must be at least equal to the sluice valve inside diameter.
2. Carefully center the sluice valve with the hole. Sluice valve must be installed perpendicular to the pipe. If the hole is larger than the sluice valve, make sure the valve does not protrude deep inside the pipeline.
3. Weld carefully all around the sluice valve to fasten it.

- When installing, apply lubricating grease to the thread to prevent seizing.
- For sensor removal there must be at least the following minimum distance of free space directly behind the installation, measured from the mounting surface of the sluice valve:

Sluice valve 269 → 950 mm
 Sluice valve 270 → 1070 mm
 Sluice valve 271 → 1000 mm

Industrial Sensor 4741

Compact closed sensor for small pipes

4-electrode conductivity sensor with internal electrodes.
Used with Dual Conductivity TCU series 3200.
Mounted with flow opening facing the incoming flow.

| Technical data | |
|----------------|---|
| Materials | PVDF, EPDM, silicone rubber, and steel W 1.4404 (AISI 316L) Flange and cable connection: steel W 1.4404 (AISI 316L) Temperature sensor PFA coated |
| Pressure | 10 bar at 130 °C |
| Cell constant | Sensor specific, factory calibrated |
| Accuracy | ± 2 % |
| Meas. range | 5...200 000 µS/cm |
| Linearity | ± 2 % per decade Below 5 µS/cm + 0.01 µS/cm |
| Temp. sensor | Pt 1000 (IEC 751 class A) Time delay T ₉₀ , 9 sec |
| Protection | IP65 splash-proof (DIN 40 050) |
| Sensor cable | PVC 18 x 0.22 mm ² screened max. temp. 70 °C |
| Cable length | Standard length 5 m COND15242/10 -> 10 m COND15242/15 -> 15 m |
| Connection | 15-pole strip connector with MF20 cable adapter |
| Weight | 1.0 kg |

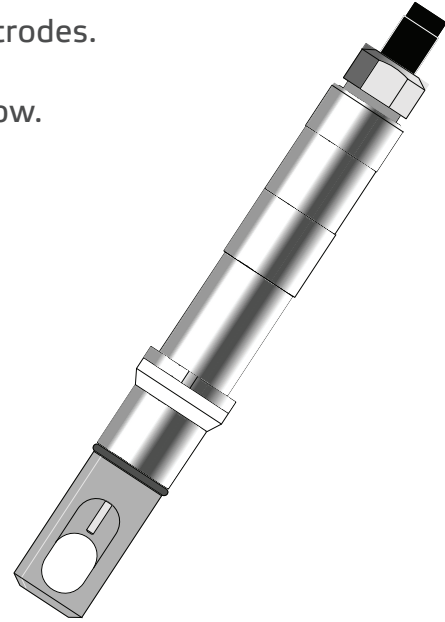

dimensions in millimeters

